

A
B
C
D
E
F

X:\1 SBB DRAWINGS\2021\21-132 WICHITA VA HOSPITAL\DWG\DESIGN\SITE CONSTRUCTION PLANS\SITE PLAN from Architect\2021_2021-07_VA_589-500_dba.schematic
 3/17/2021 4:37:34 PM
 VA FORM 08-6231

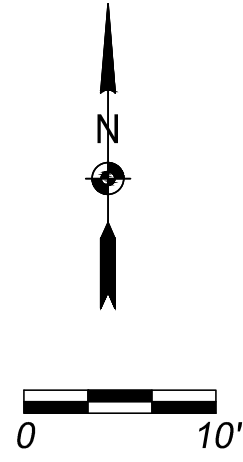
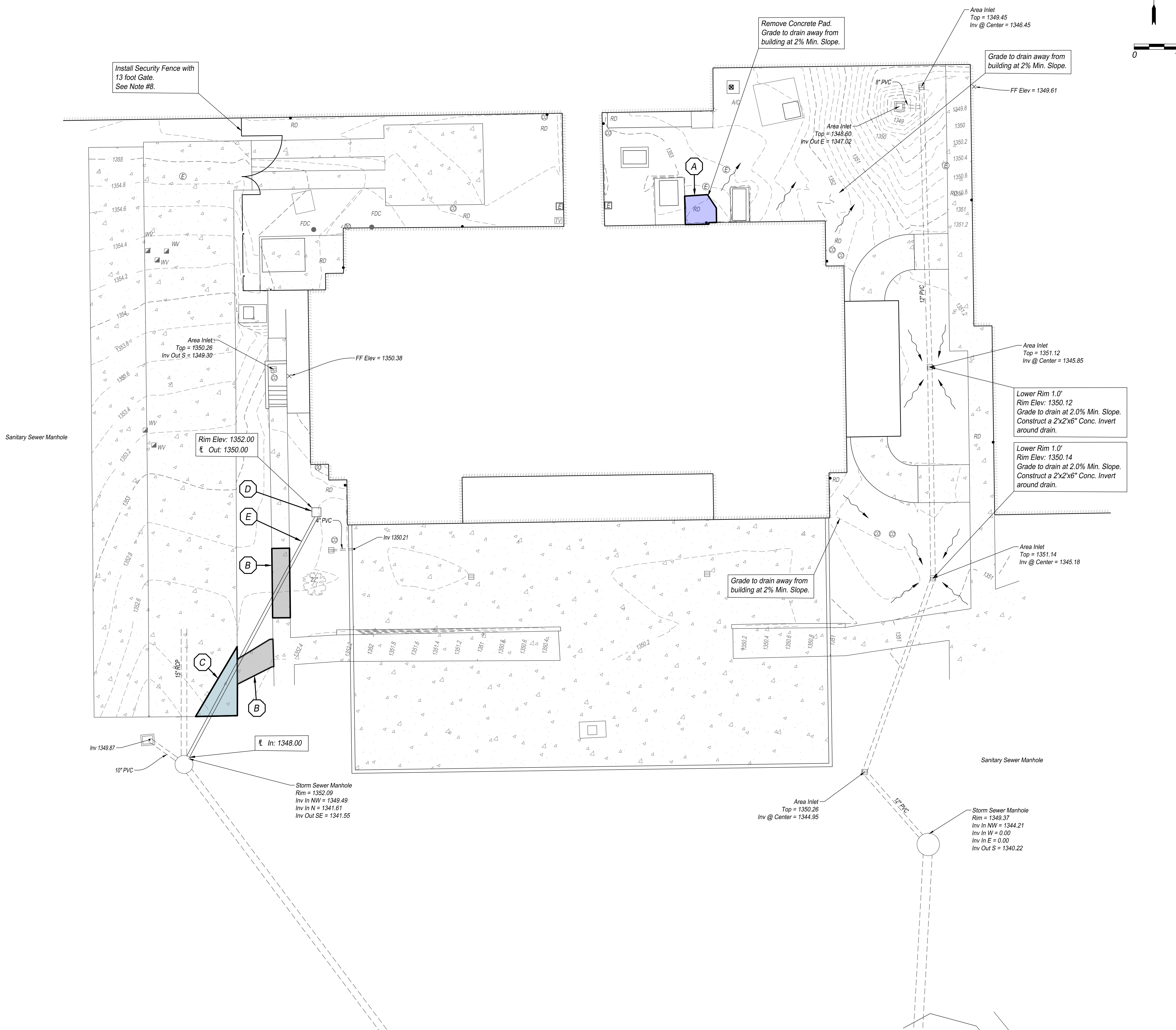

- GENERAL NOTES**
- All construction methods and materials used in the construction of the improvements that are not otherwise covered by specifications shown on these plans shall be in accordance with the Project Technical Specifications.
 - The location of all overhead and underground utilities may vary from what is indicated in these plans. It shall be the contractor's responsibility to coordinate with the utility owner to locate and flag all underground utilities whether indicated or not. No excavation will be permitted in the area of underground utilities until all such utilities have been located and identified to the satisfaction of all parties and then only with extreme care to avoid any possibility of damage to the utility.
 - All Permits and fees necessary to construct the project are the responsibility of the contractor unless otherwise noted.
 - All disturbed areas shall be fine graded, and free of ruts. The contractor shall provide owner with grass seed and fertilizer.
 - All pavement removal areas shall be full-depth saw cut to form a straight and uniform line.
 - Contractor shall provide work zone traffic control in compliance with City of Wichita Standards and the Manual on Uniform Traffic Control Devices (MUTCD) while working on or adjacent to public roadways is proceeding. The contractor shall require a Traffic Disruption Permit from the City of Wichita Engineering Division 72 hours in advance of work in the public RW.
 - Contractor to provide 7 foot tall chain-link construction panel fence around perimeter of the job site with construction signage. No snow fence shall be permitted.
 - Install Classic, Montage Commercial Welded Commercial Ornamental Steel Fence (39.6 LF) with Gate. Re: A101 - Building Plans.

- LEGEND**
- A Demolition Area
 - B Remove & Replace 4" Concrete Sidewalk (107.6 SF)
 - C Remove & Replace 8" Concrete Pavement (71.0 SF)
 - D Install 8" Nyloplast Inline Drain with 2"x2"x6" Concrete Invert.
 - E Install 8" PVC to Existing Storm Sewer Manhole.

Know what's below. Call 811 before you dig or visit us at www.kansasonecall.com



"Kansas One-Call" is the Underground Utility Notification center for the State of Kansas. Through this facility, you can notify operators of underground facilities of proposed excavations to request that the underground facilities be marked before you dig.

Kansas Statute annotated #66-1801 through #66-1815 requires anyone who engages in any type of excavation to provide advance notice of at least two full working days, but not more than 15 calendar days, excluding weekends and holidays.

The person who is doing the work is responsible for calling Kansas One-Call. If the owner contracts with a professional excavator to do the excavation, then the professional excavator is responsible for calling Kansas One-Call.

The service provided by Kansas One-Call to excavators is free of charge.

Call 785-368-3111 for emergencies with City of Topeka utilities.

Revisions:	Date:
SCHAMATIC DESIGN	01-06-2021
60% DESIGN DEVELOPMENT	02-05-2021
90% DESIGN DEVELOPMENT	03-22-2021
100% CONSTRUCTION DOCUMENTS	04-27-2021
100% FINAL CONSTRUCTION DOCUMENTS	06-11-2021
BID DOCUMENTS	09-23-2021

CONSULTANT

SBB Engineering, LLC
 transportation site development surveying
 101 South Kansas Avenue
 Topeka, Kansas 66603
 Ph: (785) 215-9630 / www.sbbeng.com

ARCHITECT/ENGINEER OF RECORD

A/E:
 Calvin L. Hinz Architects P.C.
 3705 N. 200th Street
 Elkhorn, NE 68022
 (402) 291-6941

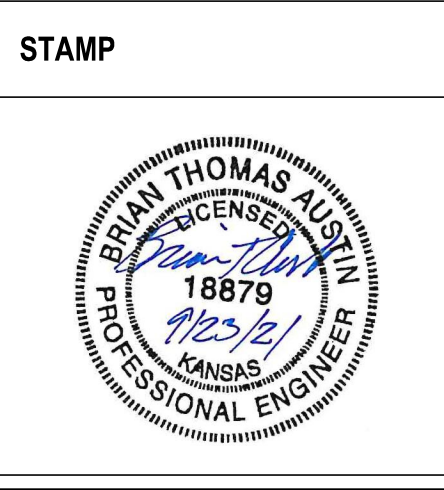

Office of Construction and Facilities Management

VA U.S. Department of Veterans Affairs

Drawing Title
SITE PLAN

Approved:

Phase
BID DOCUMENTS

FULLY SPRINKLERED

Project Title
 Robert J Dole VA Building

Location
 5500 E Kellogg Ave, Wichita, KS

Issue Date
 9/23/2021

Checked
 JWJ

Drawn
 JEM

Project Number
 589-500

Building Number
 4

Drawing Number
 CS-100

A
B
C
D
E
F
 3/17/2021 4:37:34 PM
 X:11 SBB DRAWINGS\2021\21-132 WICHITA VA HOSPITAL\DWG\DESIGN\SITE CONSTRUCTION PLANS\EROSION CONTROL PLAN.rvt
 Architect\2021_2020\07 VA 589-500_dba\mehmet

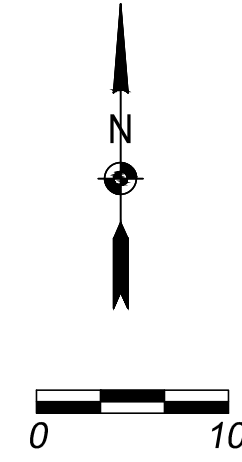

NOTES: EROSION CONTROL

GENERAL NOTES:

1. The location of all overhead and underground utilities may vary from what is indicated in these plans. It shall be the contractor's responsibility to coordinate with the utility owner to locate and flag all underground utilities whether indicated or not. No excavation will be permitted in the area of underground utilities until all such utilities have been located and identified to the satisfaction of all parties and then only with extreme care to avoid any possibility of damage to the utility.

2. All disturbed areas that are not paved or landscaped shall be seeded, fertilized and mulched in accordance with the specifications.

EROSION CONTROL GENERAL NOTES:

- The contractor shall be responsible for implementing, monitoring and maintaining Best Management Practices (BMP's) at all times during the construction on this property.
- Prior to commencement of earthwork operations, contractor shall install perimeter wattles, silt fence, and construction entrance as shown on this plan. The inlet protection and additional wattles within work area shall be installed immediately after installation of the inlets and completion of rough grading.
- Erosion control measures shall be inspected and maintained by the contractor not less than weekly or within 24 hours after a rainfall event of 0.5 inches or more. Maintenance shall include but not be limited to sediment removal and silt fence repair and/or replacement. Field adjustments may be made as necessary to ensure optimal performance.
- Contractor shall clear all surrounding parking lots and streets of any tracked debris by sweeping or scraping the existing pavement by the end of each workday and the contractor shall clean up soil washed off the construction site after a storm by the end of the next workday.
- During all soil disturbing activities, the contractor will take appropriate steps using accepted construction methods to minimize the time of exposure of unprotected soil and other construction materials to rainfall.
- Contractor shall keep a written log of when construction activities begin, erosion and sediment controls are installed, inspected and repaired.
- Erosion and sediment control measures shall not be removed until grass cover has been established or as directed by Engineer.
- All areas shall be graded to finished grade prior to seeding and mulching. All areas not part of the hardscape or other noted landscaping shall be permanently seeded, fertilized and mulched.
- All wattles shall be straw wattle WS-12 as manufactured by North American Green, or approved equal. The wattles shall be installed per manufacturer's recommendations. The contractor may use wattles and silt fence interchangeably in areas identified on the drawings.
- The contractor has the option to modify the location of the construction entrance to fit the preferred work pattern.
- The contractor shall make every effort to keep silt and debris out of the underground detention system prior to final site stabilization. The contractor shall be inspect and maintain the underground detention system not less than on a weekly basis or within 24 hours after a rainfall event of 0.5 inches or more.

WASTE DISPOSAL:

- WASTE MATERIALS:** Any waste and other unusable materials will be removed from the site on a regular basis and properly disposed of in an approved site.
- CHEMICAL WASTE:** All chemical waste materials will be collected and stored in a tightly sealed metal or other chemical resistant container. The container will meet all Local and any State Solid Waste Management Regulations. The waste materials and all disposable materials will be transported to a commercial chemical disposal facility capable of either recycling or properly disposing of the pollutants in accordance with all applicable Federal, State and Local Regulations. The State Waste Management Section Contact Number is (785) 296-1600.
- HAZARDOUS WASTE:** All hazardous waste materials, such as oil filters, petroleum products, equipment maintenance fluids and paints, shall not be stored on site and will be disposed of in the manner specified by Local, State and/or Federal Regulations. If there are questions regarding the proper handling of hazardous wastes the contractor shall immediately contact the Kansas Department of Health and Environment Hazardous Waste Section at (785) 296-1600.
- SANITARY WASTE:** Portable toilet facilities will be provided on the project site and serviced by the provider on a regular basis.

MATERIAL MANAGEMENT PRACTICES:

GOOD HOUSEKEEPING: The following good housekeeping practices will be followed on-site during construction.

- All materials stored on-site will be stored in a neat, orderly manner in original containers if appropriate.
- Products will be kept in their original containers with the original manufacturer's labels.
- Manufacturers' Recommendations for proper use and disposal will be followed.

SPILL PREVENTION:

- PETROLEUM PRODUCTS:** All on-site vehicles will be monitored for leaks and receive regular preventative maintenance to reduce the chance of leakage. Petroleum products will be stored in tightly sealed containers which are clearly labeled.
- FERTILIZERS:** Fertilizers used will be applied only in the minimum amounts recommended by the manufacturer. Once applied, fertilizer will be worked into the soil to limit exposure to storm water. Fertilizer shall not be stored on-site.
- CONCRETE TRUCKS:** Concrete trucks are limited to a designated area to wash out or discharge surplus concrete or drum wash water on the site. Proper signage shall be installed and maintained on site defining directions to and locations of the specified wash out area. If a wash out area cannot be designated or maintained on site, concrete wash out and disposal may be prohibited at the owners discretion.

LEGEND

- Silt Fence
- Curb Inlet Protection
- Existing Contours
- Proposed Contours
- Construction / Disturbed Limits
- Construction Entrance
- Concrete Washout Area

EROSION CONTROL PLAN KEY NOTES

- Area Inlet Protection

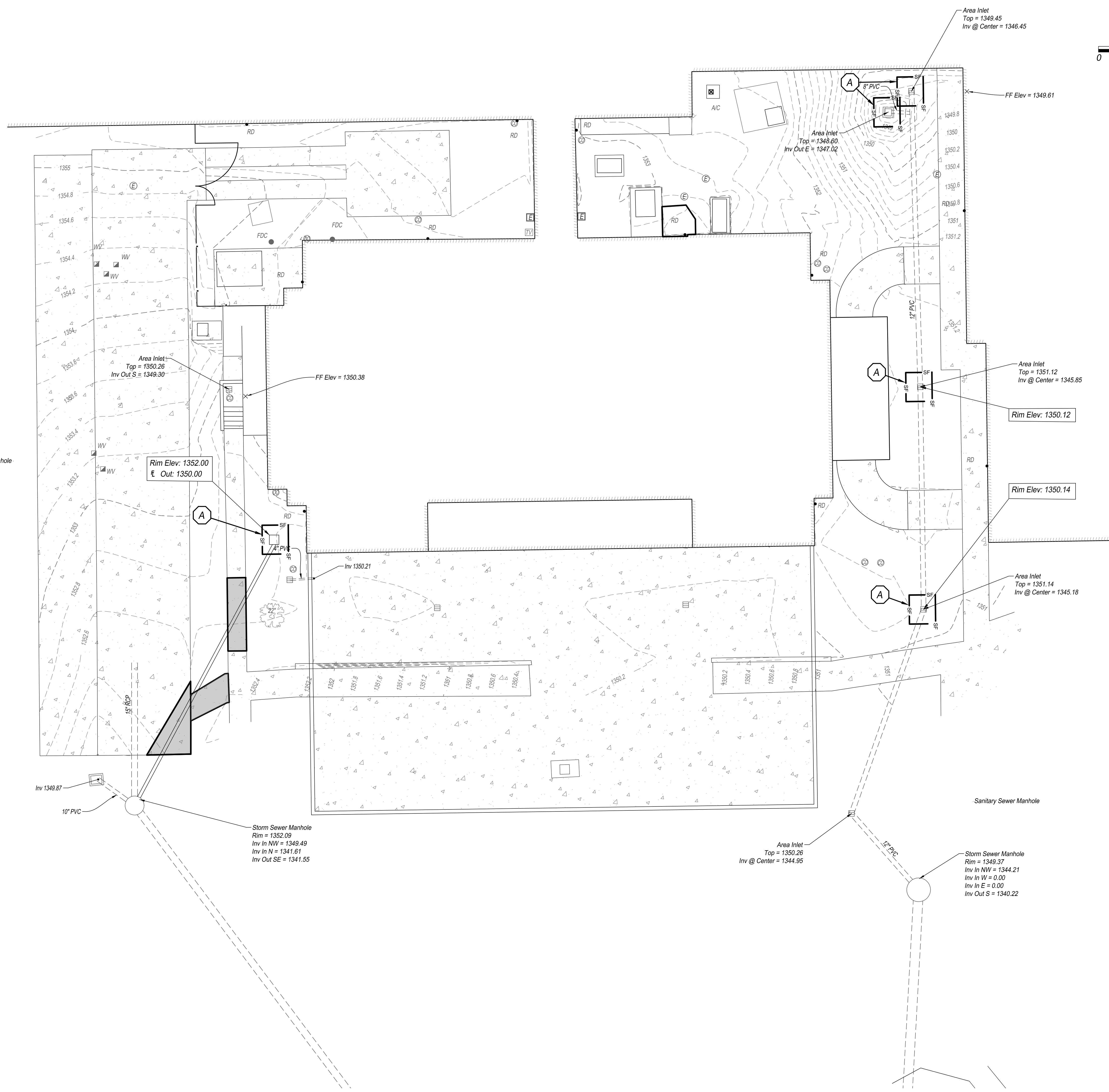

Revisions:	Date:
BID DOCUMENTS	09-23-2021
100% FINAL CONSTRUCTION DOCUMENTS	08-11-2021
100% CONSTRUCTION DOCUMENTS	04-27-2021
90% DESIGN DEVELOPMENT	03-22-2021
60% DESIGN DEVELOPMENT	02-05-2021
SCHMATIC DESIGN	01-06-2021

CONSULTANT

SBB Engineering, LLC
 transportation site development surveying
 101 South Kansas Avenue
 Topeka, Kansas 66603
 Ph: (785) 215-8630 / www.sbbeng.com

ARCHITECT/ENGINEER OF RECORD

A/E:
 Calvin L. Hinz Architects P.C.
 3705 N. 200th Street
 Elkhorn, NE 68022
 (402) 291-6941

STAMP

Office of Construction and Facilities Management

VA U.S. Department of Veterans Affairs

Drawing Title
EROSION CONTROL PLAN

Approved:

Phase
BID DOCUMENTS

FULLY SPRINKLERED

Project Title
 Robert J Dole VA Building

Location
 5500 E Kellogg Ave, Wichita, KS

Issue Date
 9/23/2021

Checked
 JWJ

Drawn
 JEM

Project Number
 589-500

Building Number
 4

Drawing Number
CEC-100

8" - 15" NYLOPLAST DRAIN BASIN WITH BRONZE GRATE

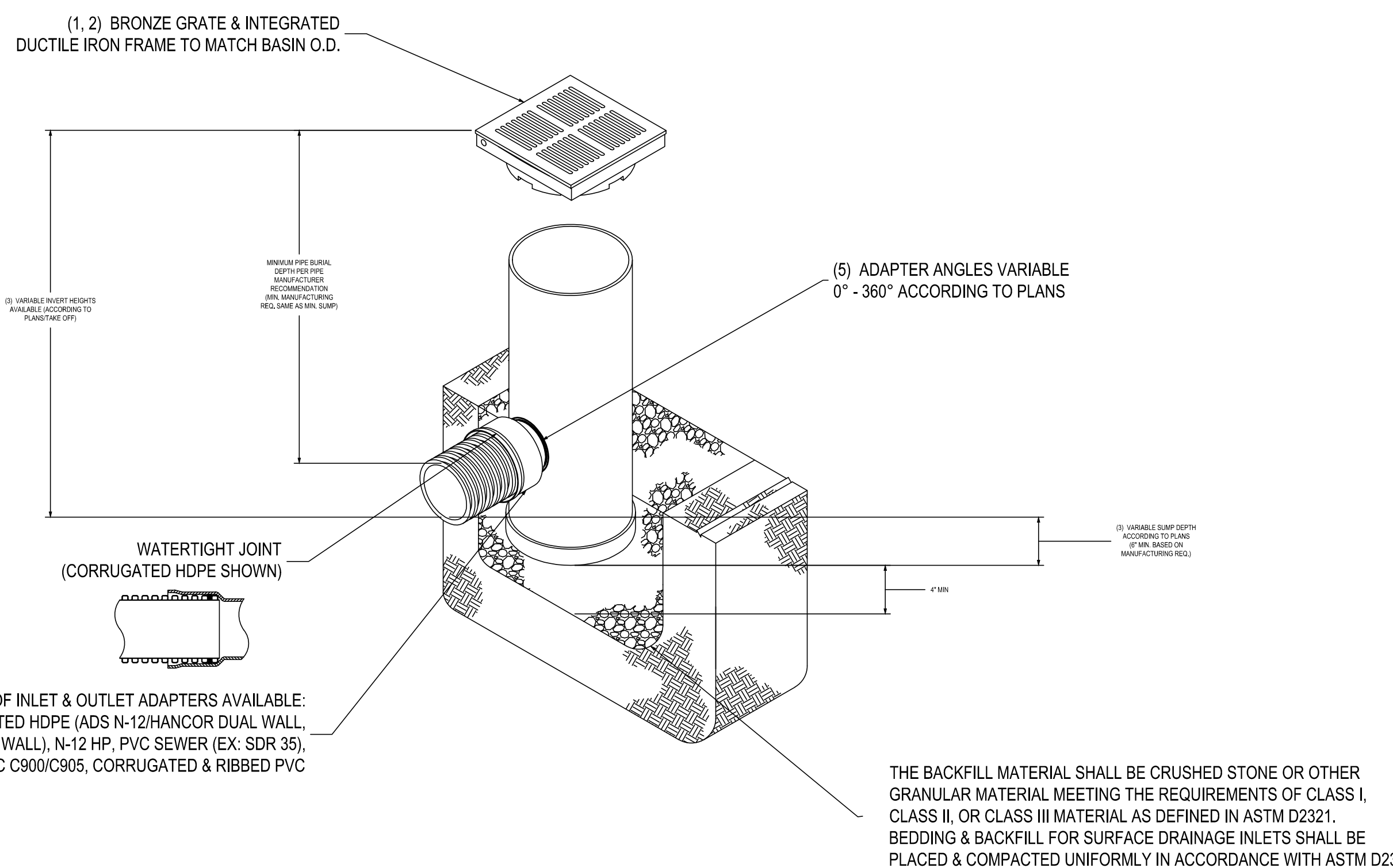

- 1 - 8" - 15" GRATES SHALL BE SOLID BRASS METAL.
- 2 - 12" & 15" FRAMES SHALL BE DUCTILE IRON PER ASTM A536 GRADE 70-50-05. 8" & 10" BRONZE GRATES FIT DIRECTLY ONTO DRAIN BASINS WITH THE USE OF A PVC BODY TOP. SEE DRAWING NO. 7001-110-045.
- 3 - DRAIN BASIN TO BE CUSTOM MANUFACTURED ACCORDING TO PLAN DETAILS. RISERS ARE NEEDED FOR BASINS OVER 84" DUE TO SHIPPING RESTRICTIONS. SEE DRAWING NO. 7001-110-045.
- 4 - DRAINAGE CONNECTION STUB JOINT TIGHTNESS SHALL CONFORM TO ASTM D3212 FOR CORRUGATED HDPE (ADS N-12/HANCOR DUAL WALL, N-12 HP, & PVC SEWER).
- 5 - ADAPTERS CAN BE MOUNTED ON ANY ANGLE 0° TO 360°, TO DETERMINE MINIMUM ANGLE BETWEEN ADAPTERS SEE DRAWING NO. 7001-110-012.
- 6 - 8" - 15" BRONZE GRATES HAVE NO LOAD RATING.

THIS PRINT DISCLOSES SUBJECT MATTER IN WHICH NYLOPLAST HAS PROPRIETARY RIGHTS. THE RECEIPT OR POSSESSION OF THIS PRINT DOES NOT CONFER, TRANSFER, OR LICENSE THE USE OF THE DESIGN OR TECHNICAL INFORMATION SHOWN HEREIN. REPRODUCTION OF THIS PRINT OR ANY INFORMATION CONTAINED HEREIN, OR MANUFACTURE OF ANY ARTICLE HEREFROM, FOR THE DISCLOSURE TO OTHERS IS FORBIDDEN, EXCEPT BY SPECIFIC WRITTEN PERMISSION FROM NYLOPLAST.		DRAWN BY EBC DATE 03-25-10 REVISOR BY NMH DATE 03-11-16 DWG SIZE A SCALE 1:20 SHEET 1 OF 1	MATERIAL PROJECT NO./NAME TITLE DRAIN BASIN WITH BRONZE GRATE QUICK SPEC INSTALLATION DETAIL DWG NO. 7001-110-396 REV C	3130 VERONA AVE BUFORD, GA 30518 PHN (770) 932-2443 FAX (770) 932-2490 www.nyloplast-us.com
--	--	--	--	---

1299CGPB

APPROX. DRAIN AREA = 50.60 SQ IN
 APPROX. WEIGHT WITH FRAME = 35.04 LBS

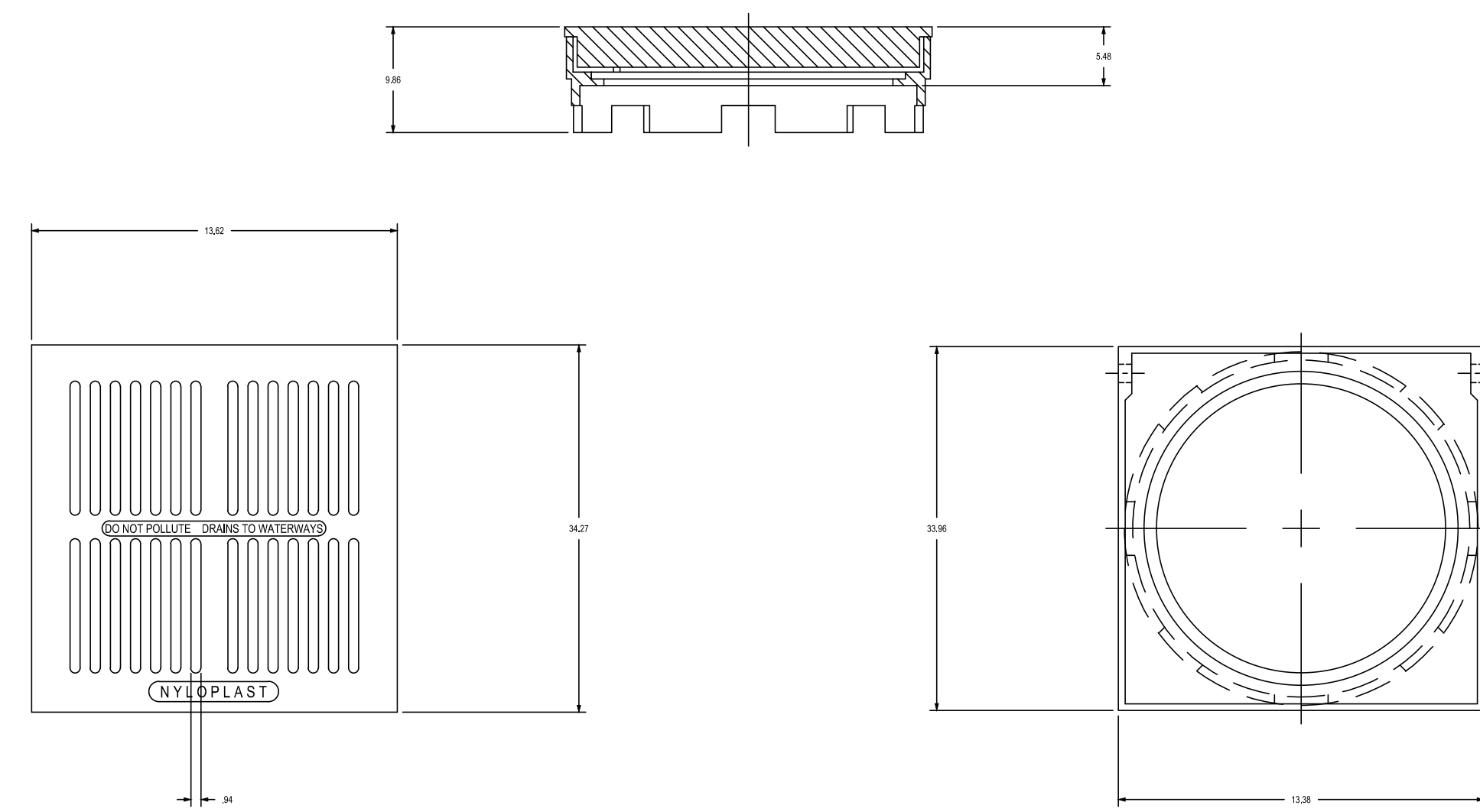

DIMENSIONS ARE FOR REFERENCE ONLY
 ACTUAL DIMENSIONS MAY VARY

THIS PRINT DISCLOSES SUBJECT MATTER IN WHICH NYLOPLAST HAS PROPRIETARY RIGHTS. THE RECEIPT OR POSSESSION OF THIS PRINT DOES NOT CONFER, TRANSFER, OR LICENSE THE USE OF THE DESIGN OR TECHNICAL INFORMATION SHOWN HEREIN. REPRODUCTION OF THIS PRINT OR ANY INFORMATION CONTAINED HEREIN, OR MANUFACTURE OF ANY ARTICLE HEREFROM, FOR THE DISCLOSURE TO OTHERS IS FORBIDDEN, EXCEPT BY SPECIFIC WRITTEN PERMISSION FROM NYLOPLAST.

DRAWN BY EBC	MATERIAL DUCTILE IRON FRAME BRONZE GRATE	3130 VERONA AVE BUFORD, GA 30518 PHN (770) 932-2443 FAX (770) 932-2490 www.nyloplast-us.com
DATE 3-6-06	PROJECT NO./NAME	TITLE
REVISOR BY EBC	12 IN BRONZE GRATE ASSEMBLY	DWG NO. 7001-110-205
DATE 3-13-10	DWG SIZE A	SCALE 1:8
SHEET 1 OF 1		

8" - 15" NYLOPLAST INLINE DRAIN WITH BRONZE GRATE

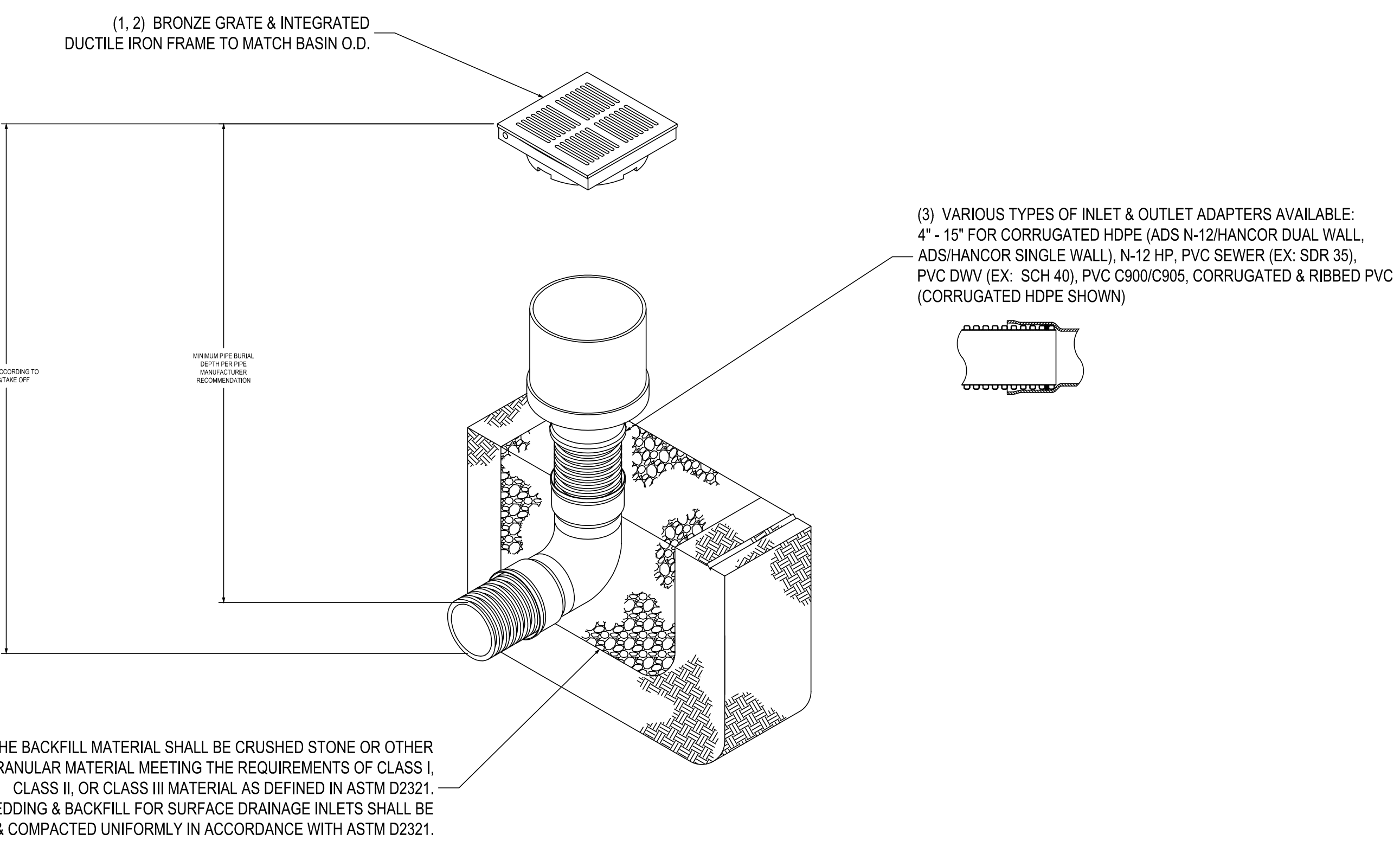

- 1 - 8" - 15" GRATES SHALL BE SOLID BRASS METAL.
- 2 - 12" - 30" FRAMES SHALL BE DUCTILE IRON PER ASTM A536 GRADE 70-50-05. 8" & 10" BRONZE GRATES FIT DIRECTLY ONTO INLINE DRAINS SEE DRAWING NO. 7003-110-000 & 7003-110-001.
- 3 - DRAINAGE CONNECTION STUB JOINT TIGHTNESS SHALL CONFORM TO ASTM D3212 FOR CORRUGATED HDPE (ADS N-12/HANCOR DUAL WALL, N-12 HP, & PVC SEWER).
- 4 - 8" - 15" BRONZE GRATES HAVE NO LOAD RATING.

THIS PRINT DISCLOSES SUBJECT MATTER IN WHICH NYLOPLAST HAS PROPRIETARY RIGHTS. THE RECEIPT OR POSSESSION OF THIS PRINT DOES NOT CONFER, TRANSFER, OR LICENSE THE USE OF THE DESIGN OR TECHNICAL INFORMATION SHOWN HEREIN. REPRODUCTION OF THIS PRINT OR ANY INFORMATION CONTAINED HEREIN, OR MANUFACTURE OF ANY ARTICLE HEREFROM, FOR THE DISCLOSURE TO OTHERS IS FORBIDDEN, EXCEPT BY SPECIFIC WRITTEN PERMISSION FROM NYLOPLAST.		DRAWN BY EBC DATE 03-25-10 REVISOR BY NMH DATE 03-15-16 DWG SIZE A SCALE 1:20 SHEET 1 OF 1	MATERIAL PROJECT NO./NAME TITLE INLINE DRAIN WITH BRONZE GRATE QUICK SPEC INSTALLATION DETAIL DWG NO. 7003-110-656 REV C	3130 VERONA AVE BUFORD, GA 30518 PHN (770) 932-2443 FAX (770) 932-2490 www.nyloplast-us.com
--	--	--	---	---

X:\11 SBB DRAWINGS\2021\21-132 WICHITA VA HOSPITAL\DWG\DESIGN\SITE CONSTRUCTION PLANS\SITE PLAN from Architect\2021_2021-07_VA_589-500_dba\sheet.dwg
 3/17/2021 4:37:34 PM
 F

BID DOCUMENTS	09-23-2021
100% FINAL CONSTRUCTION DOCUMENTS	08-11-2021
100% CONSTRUCTION DOCUMENTS	04-27-2021
90% DESIGN DEVELOPMENT	03-22-2021
60% DESIGN DEVELOPMENT	02-05-2021
SCHMATIC DESIGN	01-06-2021
Revisions:	Date:

CONSULTANT

SBB Engineering, LLC
 transportation site development surveying
 101 South Kansas Avenue
 Topeka, Kansas 66603
 Ph: (785) 215-8630 / www.sbbeng.com

ARCHITECT/ENGINEER OF RECORD

A/E:
 Calvin L. Hinz Architects P.C.
 3705 N. 200th Street
 Elkhorn, NE 68022
 (402) 291-6941

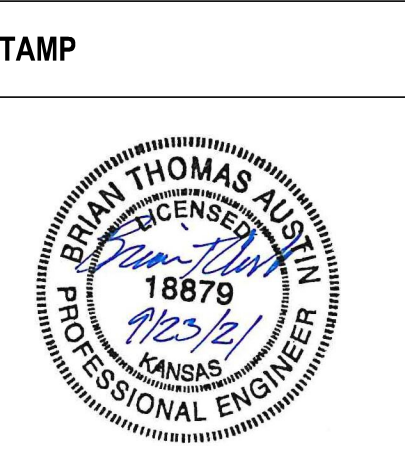

Office of Construction and Facilities Management

VA U.S. Department of Veterans Affairs

Drawing Title
STORMWATER DETAILS

Approved:

Phase
BID DOCUMENTS

FULLY SPRINKLERED

Project Title
 Robert J Dole VA Building

Location
 5500 E Kellogg Ave, Wichita, KS

Issue Date
 9/23/2021

Checked
 JWJ

Drawn
 JEM

Project Number
 589-500

Building Number
 4

Drawing Number
 CD2T-101

3/17/2021 4:37:34 PM
X:\1 SBB DRAWINGS\2021\21-132 WICHITA VA HOSPITAL\DWG\DESIGN\SITE CONSTRUCTION\PLANS\SITE PLAN.dwg
Architect: 2021-07 VA 589-500_dba@mednet

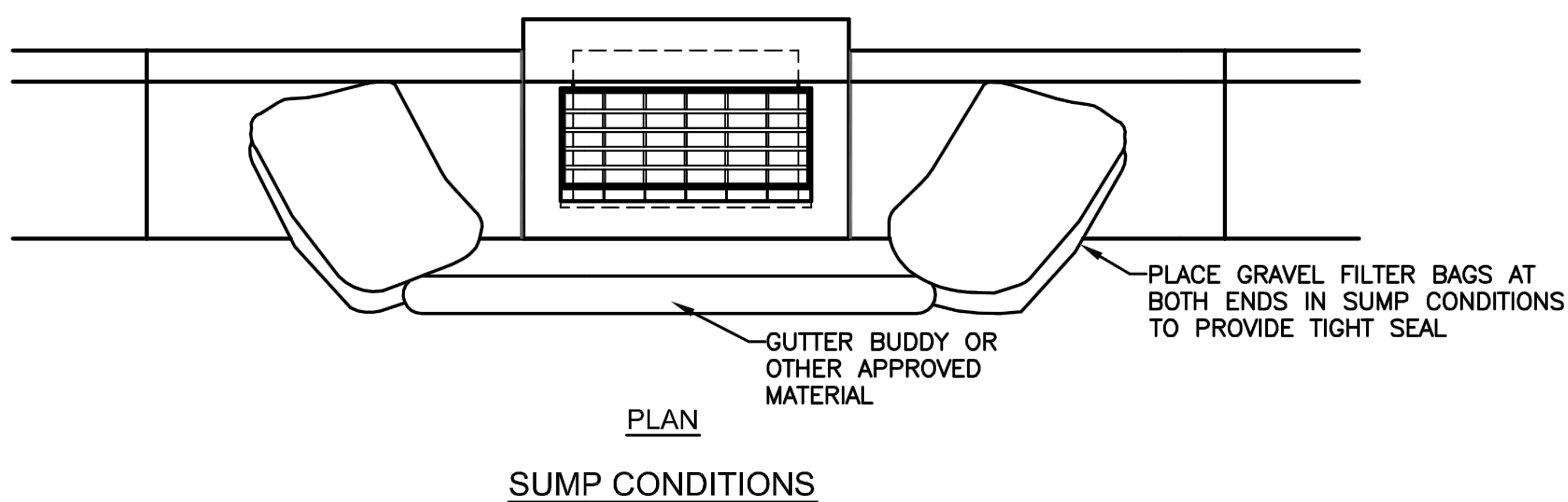
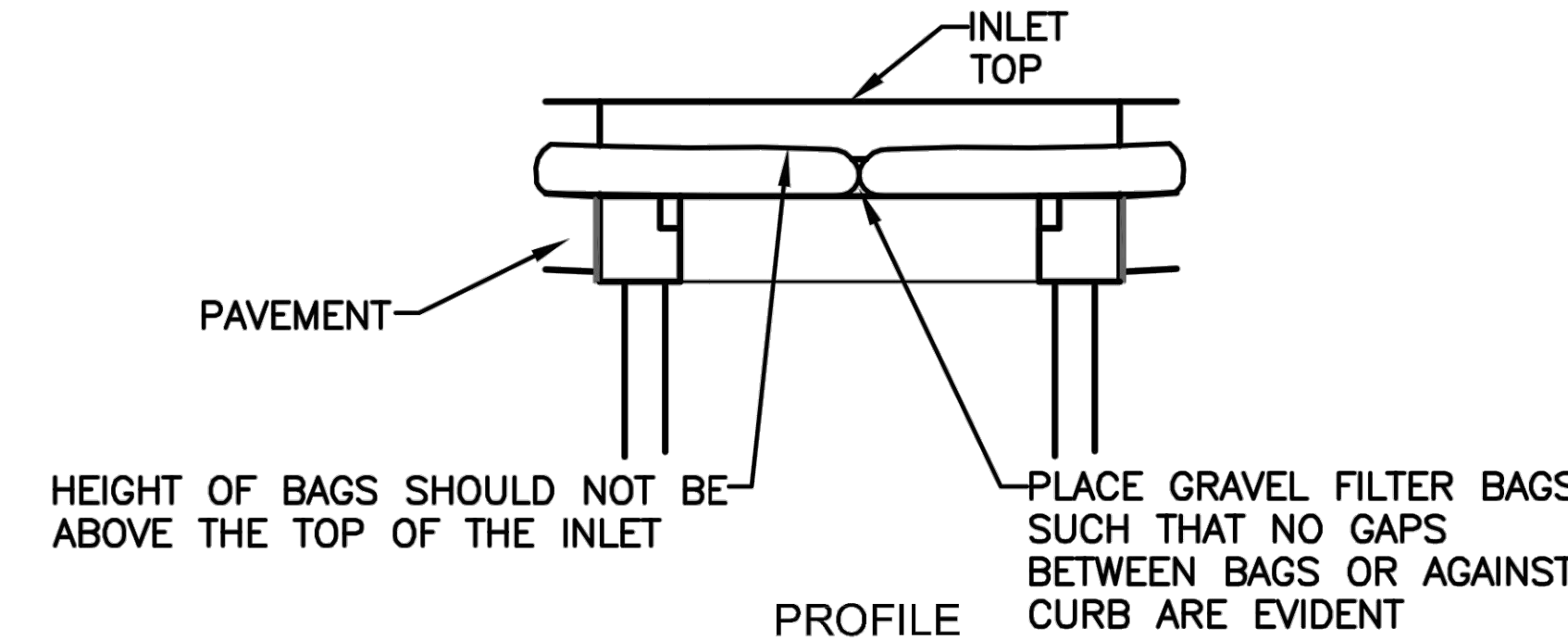
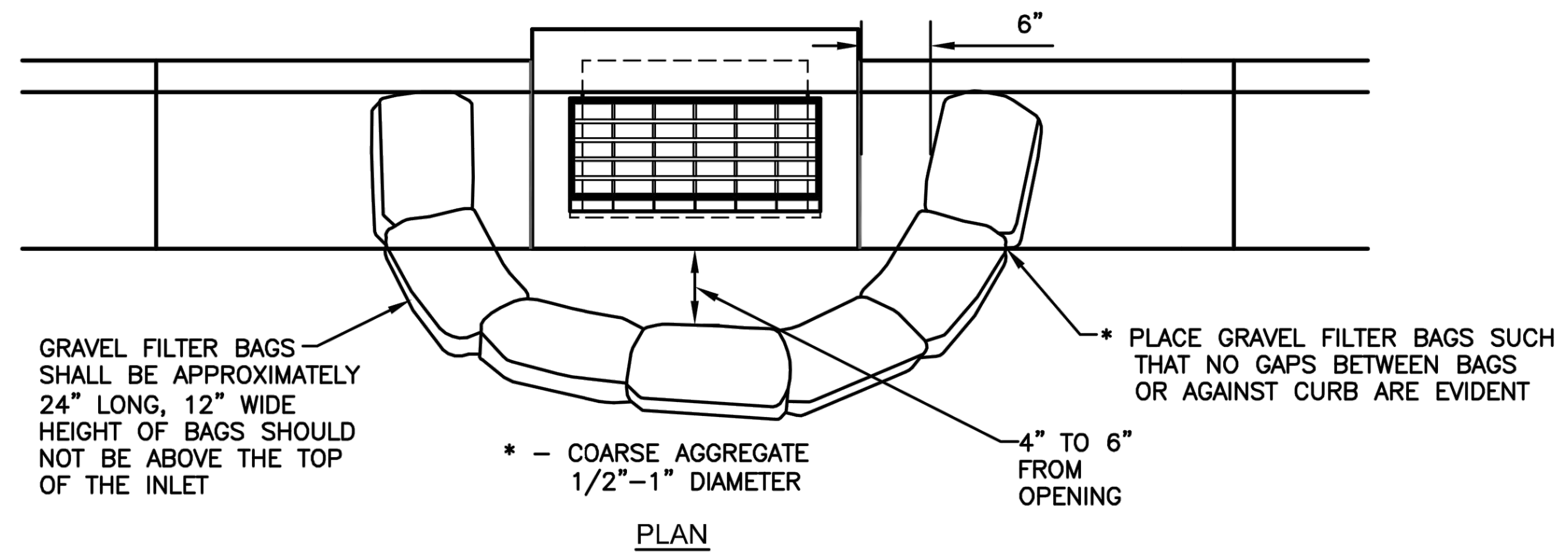

NOTE:
DO NOT BLOCK INLET OPENING - STORMWATER MUST BE ALLOWED TO FLOW TO DRAIN AND NOT BYPASS TO DOWNSTREAM.

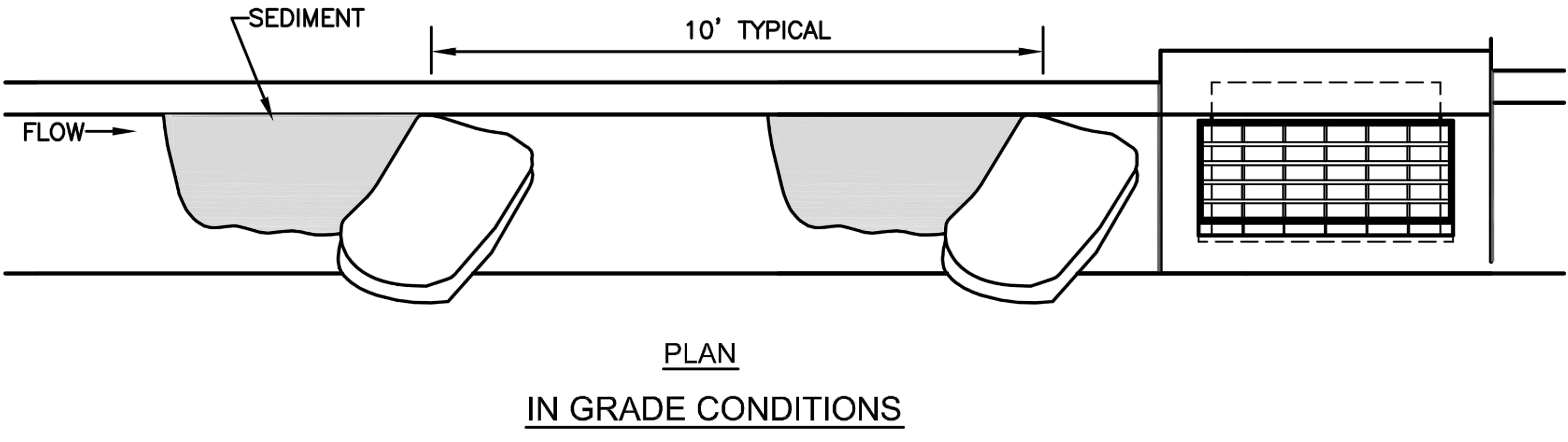

- NOTES:
1. OTHER APPROVED CURB INLET SEDIMENT FILTERS MAY BE USED.
 2. IMMEDIATELY FOLLOWING INLET CONSTRUCTION AND PRIOR TO CONSTRUCTION OF CURB AND INLET THROAT, PROTECT INLET OPENING AROUND PERIMETER. SEE AREA INLET DETAIL THIS PAGE.
 3. CONTRACTOR TO CLEAN OUT SEDIMENT AFTER EACH SIGNIFICANT RAINFALL EVENT.
 4. DURING CONSTRUCTION GRAVEL FILTER BAGS SHALL BE REPLACED PRIOR TO DEGRADATION.
 5. ANY SEDIMENT OR GRAVEL DEPOSITED IN INLET SHALL BE REMOVED PROMPTLY.

CURB INLET SEDIMENT PROTECTION

BID DOCUMENTS	09-23-2021
100% FINAL CONSTRUCTION DOCUMENTS	08-11-2021
100% CONSTRUCTION DOCUMENTS	04-27-2021
90% DESIGN DEVELOPMENT	03-22-2021
60% DESIGN DEVELOPMENT	02-05-2021
SCHAMATIC DESIGN	01-06-2021
Revisions:	Date:

CONSULTANT

SBB Engineering, LLC
transportation site development surveying
101 South Kansas Avenue
Topeka, Kansas 66603
Ph: (785) 215-9830 / www.sbbeng.com

ARCHITECT/ENGINEER OF RECORD

A/E:
Calvin L. Hinz Architects P.C.
3705 N. 200th Street
Elkhorn, NE 68022
(402) 291-6941

STAMP

Office of Construction and Facilities Management

Drawing Title
EROSION CONTROL DETAILS

Approved:

Phase
BID DOCUMENTS

FULLY SPRINKLERED

Project Title
Robert J Dole VA Building

Location
5500 E Kellogg Ave, Wichita, KS

Issue Date
9/23/2021

Checked
JWL

Drawn
JEM

Project Number
589-500

Building Number
4

Drawing Number
CDET-102