

GENERAL NOTES

ALL ACM ABATEMENT OR ENCLOSURE WORK SHALL BE PERFORMED BY TRAINED/LICENSED ASBESTOS ABATEMENT CONTRACTOR WITHIN A FULL CONTAINMENT UNDER NEGATIVE PRESSURE (NPE).

ALL HVAC AIR INTAKES WITHIN NPE SHALL BE SHUT DOWN AND ISOLATED WITH CRITICAL BARRIERS DURING ACTIVE ACM REMOVAL OR ENCLOSURE WORK. WORK TO BE SCHEDULED WITH GENERAL CONTRACTOR AND OWNER TO ACCOMMODATE CONSTRUCTION AND FACILITY REQUIREMENTS.

WHERE NEGATIVE PRESSURE ENCLOSURES ARE PLACED IN ACTIVE TR ROOMS, CONTRACTOR TO MAINTAIN COOLING AIR FLOW TO OPERATING ELECTRONICS BY TUNNELING METHODS OR SIMILAR.

WORKERS PERFORMING ACM REMOVAL OR ENCLOSURE SHALL DON, AT MINIMUM, HALF FACE AIR PURIFYING RESPIRATORS WITH P100 FILTERS, DISPOSABLE DUST SUITS (WITH BOOT COVERS) AND GLOVES DURING ACTIVE TASKS, WHICH SHALL BE SUPPLEMENTED WITH USE OF POWERED AIR PURIFYING RESPIRATORS.

ACM REMOVAL WORK AREAS SHALL BE PREPARED IN ACCORDANCE WITH THE FOLLOWING: A) ALL FLOORS, CEILINGS AND WALLS SHALL BE ISOLATED USING 2-LAYERS OF 6-MIL POLY SHEETING; B) OSHA ASBESTOS SIGNAGE AT ENTRANCE TO REGULATED AREAS; C) SINGLE-POINT OF ENTRY WITH 3-STAGE WET DECONTAMINATION STATION TO ALLOW WORKERS TO REMOVE PPE, WASH AND VACUUM THEMSELVES OFF PRIOR TO EXITING THE REGULATED WORK AREA; D) MAINTAINED UNDER NEGATIVE PRESSURE (-0.02 IN WG OR BETTER) USING HEPA FILTERED AIR MACHINES WITH EXHAUST ROUTED TO OUTDOORS; E) MINIMUM OF 4 AIR CHANGES PER HOUR; F) CLEAN/CHANGE ROOM SUFFICIENT FOR WORKERS TO CHANGE INTO STREET CLOTHES (OPAQUE POLY REQUIRED AS NEEDED FOR PRIVACY); G) RENEWABLE ADHESIVE MATS IMMEDIATELY OUTSIDE OF REGULATED WORK AREA TO ENSURE FOOT TRAFFIC DOES NOT SPREAD DUST/DEBRIS TO OTHER AREAS OF FACILITY.

ACM WORK TO BE PERFORMED USING THE FOLLOWING CONTROLS: A) HEPA FILTERED VACUUM FOR CONTINUOUS AND FINAL CLEANUP; B) ONLY MANUAL REMOVAL MEANS/TOOLS ARE ALLOWED TO DISTURB ACM (MECHANICAL TOOLS PROHIBITED FOR ACM REMOVAL).

REGULATED WORK AREA IS TO BE CLEANED BY CONTRACTOR FOLLOWING COMPONENT REMOVAL USING STANDARD HEPA VACUUM & WET WIPING METHODS AND VISUALLY INSPECTED AND CLEARANCE SAMPLED BY VA REPRESENTATIVE TO VERIFY COMPLETION OF SCOPE.

VPIH IS TO BE RESPONSIBLE FOR PERIMETER AIR MONITORING AND FINAL CLEARANCE AIR SAMPLING/VISUAL INSPECTION REQUIREMENTS.

CONTRACTOR TO BE RESPONSIBLE FOR OSHA EMPLOYEE EXPOSURE MONITORING REQUIREMENTS.

ALL WASTE PRODUCED DURING REMEDIATION PHASE SHALL BE COLLECTED, CONTAINERIZED, LABELED, CHARACTERIZED AND DISPOSED IN ACCORDANCE WITH SPECIFICATION 02.82.11

ALL WASTE CONTAINERS, EQUIPMENT, ETC. SHALL BE WET WIPED PRIOR TO LEAVING REGULATED WORK AREA.

NIGHTS WORK IS TO BE PERFORMED DURING OFF HOURS FROM 5:00 PM - 7:00 AM MONDAY THROUGH FRIDAY AND WEEKEND WORK FRIDAY 6 PM THROUGH SUNDAY. WORK IS PROHIBITED ON FEDERAL HOLIDAYS.

**FULLY SPRINKLERED
100% BID SET**

No.	REVISION DESCRIPTION	DATE	CONSULTANTS:			ARCHITECT:	STAMP:	Drawing Title ENVIRONMENTAL REMEDIATION - GENERAL NOTES	Project Title CONSTRUCT INFILL OF BUILDING 26 AND RENOVATE SPECIALTY CARE CLINICS	Project Number 589-704	Veterans Health Administration VA U.S. Department of Veterans Affairs
			STRUCTURAL / CIVIL ENGINEER H2B, INC. 1225 N. LOOP WEST, SUITE 800 HOUSTON, TX 77008 (713) 864-2900	MECH / ELEC / PLUMB / TECH ENGINEER SPUR DESIGN 11020 KING STREET, SUITE 350 OVERLAND PARK, KS 66210 (405) 842-6100	FIRE PROTECTION ENGINEER POOLE FIRE PROTECTION, INC. 19910 WEST 161ST STREET OLATHE, KANSAS 66062 (913) 829-8600		VA Health Care System Approval:	Location 5500 EAST KELLOGG AVENUE WICHITA, KANSAS 67218	Building Number 26		
			INDUSTRIAL HYGIENIST RSH 1225 N. LOOP WEST, SUITE 800 HOUSTON, TX 77008 (713) 864-2900	HEALTHCARE PLANNER INNOVA GROUP 3190 N. SIWAN ROAD TUCSON, AZ 85712 (520) 886-8650	PHYSICAL SECURITY FORCE PROTECT 1225 N. LOOP WEST, SUITE 800 HOUSTON, TX 77008 (713) 864-2900			Date 12/21/2022	Checked JR	Drawn CD	
									Drawing Number HA-000	Drawing # 7 OF 190	

three inches = one foot
 one and one-half inches = one foot
 one inch = one foot
 three quarters inch = one foot
 one half inch = one foot
 one quarter inch = one foot
 three eighths inch = one foot
 one eighth inch = one foot
 one sixteenth inch = one foot

1 2 3 4 5 6 7 8 9

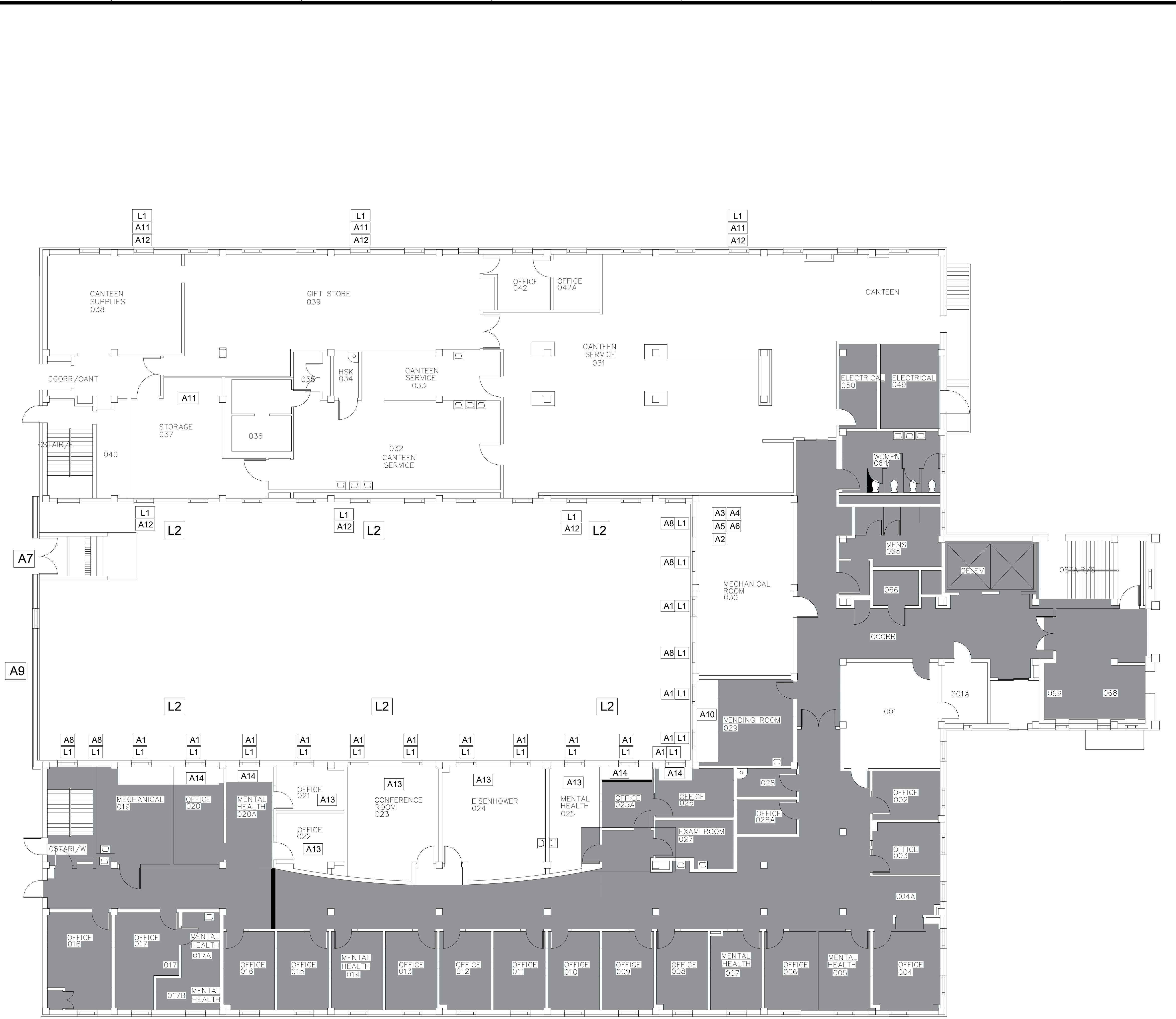

1 GROUND FLOOR - PHASE 1 ENVIRONMENTAL REMEDIATION
 1/8" = 1'-0"

KEY NOTES

- A1 REMOVE WINDOW ASSEMBLIES WITH UNDERLYING HIDDEN ASBESTOS CAULK WITHIN A NEGATIVE PRESSURE ENCLOSURE, 13 WINDOW ASSEMBLIES.
 - A2 REMOVE CAL-MAG AND AIRCELL ASBESTOS PIPE INSULATION AND MUDDER FITTING USING GLOVEBAG METHODS WITHIN A NEGATIVE PRESSURE ENCLOSURE, 80 LF.
 - A3 REMOVE ASBESTOS FLOOR TILE WITH UNDERLYING ASBESTOS BLACK MASTIC WITHIN A NEGATIVE PRESSURE ENCLOSURE, 20 SF.
 - A4 REMOVE DAMAGED REMNANT ASBESTOS BLACK MASTIC ON CONCRETE FLOOR USING SOLVENT AND MANUAL MEANS WITHIN A NEGATIVE PRESSURE ENCLOSURE, 200 SF.
 - A5 REMOVE ASBESTOS PIPE INSULATION (MINERAL WOOL BASE) WITH INTERMITTENT ASBESTOS WHITE SEALANT USING GLOVEBAG METHODS WITHIN A NEGATIVE PRESSURE ENCLOSURE, 275LF.
 - A6 REMOVE HVAC AND DUCT INSULATION WITH ASBESTOS WHITE SEAM SEALANT AND STICKPIN ADHESIVE ON AC-26AC-2 AND ASSOCIATED DUCTS USING MANUAL NON-DESTRUCTIVE METHODS WITHIN A NEGATIVE PRESSURE ENCLOSURE, 290 SF.
 - A7 REMOVE PRESUMED ASBESTOS FIRE DOORS AND FRAMES AND ASSOCIATED CAULKS WITHIN A NEGATIVE PRESSURE CONTAINMENT, 1 ASBESTOS DOUBLE DOOR SYSTEM, RELATED CAULK AND FRAME.
 - A8 REMOVE LOUVER AND REMAINING WINDOW SUB-ASSEMBLY WITH UNDERLYING HIDDEN ASBESTOS CAULK WITHIN A NEGATIVE PRESSURE ENCLOSURE, 5 LOUVER/ WINDOW ASSEMBLIES.
 - A9 BUILDING 61: REMOVE SEALED ASBESTOS FIRE HATCH AND FRAME USING MANUAL MEANS WITHIN A REGULATED AREA, 1 FIRE HATCH AND FRAME
 - A10 REMOVE AIR GRILLE WITH UNDERLYING HIDDEN ASBESTOS CAULK WITHIN A NEGATIVE PRESSURE ENCLOSURE, 1 GRILLE.
 - A11 REMOVE NON-ASBESTOS ACT CEILING TILES AND HVAC DUCT INSULATION WITH ASBESTOS WHITE SEAM SEALANT USING MANUAL NON-DESTRUCTIVE METHODS WITHIN A NEGATIVE PRESSURE ENCLOSURE, 60 SF AND 4 ENCLOSURES AND 320 SF OF CEILING TILES. COORDINATE TIE-IN LOCATIONS AND PERFORM WORK ON NIGHTS AND WEEKENDS. REFER TO DRAWING MH101. STORE CEILING TILES FOR REPLACEMENT BY OTHERS.
 - A12 REMOVE LOUVER/GRILLE AND ASSOCIATED ASBESTOS CAULKS, BRICK INFILL AND REMAINING WINDOW SUB-ASSEMBLIES WITH ASBESTOS CAULKS, AND FULL WINDOW ASSEMBLIES WITH UNDERLYING HIDDEN ASBESTOS CAULK WITHIN A NEGATIVE PRESSURE ENCLOSURE, 4 LOUVERS AND 1 GRILLE AND 2 HISTORIC WINDOW BRICK INFILLS WITH WINDOW SUB-ASSEMBLIES AND 3 WINDOW ASSEMBLIES AND 3 ENCLOSURES. COORDINATE TIE-IN LOCATIONS AND PERFORM WORK ON NIGHTS AND WEEKENDS. COORDINATE EXTENTS AND LOCATIONS.
 - A13 REMOVE NON-ASBESTOS 16"x16" FLOOR TILE AND LEVELING COMPOUND AND UNDERLYING ASBESTOS BLACK MASTIC USING MANUAL MEANS ALL WITHIN A NEGATIVE PRESSURE ENCLOSURE, 1,150 SF EACH.
 - A14 FLOOR COVERING WITH UNDERLYING ASBESTOS BLACK MASTIC AND ASBESTOS WHITE SEALANT ON HVAC INSULATION, PROTECT AS NECESSARY
 - L1 REMOVE WINDOW ASSEMBLIES WITH LBP PAINTED SUB-COMPONENTS AND SCRAPE AND STABILIZE METAL LINTELS WITHIN A NEGATIVE PRESSURE CONTAINMENT, 23 ASSEMBLIES.
 - L2 REMOVE BLACK LBP ON STORM WATER DOWNSPOUT BOOTS USING MANUAL METHODS. ESTABLISH A REGULATED AREA AND USE CHEMICAL STRIPPER, DROP CLOTHS AND HYGIENE PROCEDURES, 6 BOOTS.
- AREA NOT WITHIN PROJECT OR PHASE SCOPE

FULLY SPRINKLERED
100% BID SET

	<table border="1" style="width: 100%; border-collapse: collapse;"> <thead> <tr> <th>No.</th> <th>REVISION DESCRIPTION</th> <th>DATE</th> </tr> </thead> <tbody> <tr><td> </td><td> </td><td> </td></tr> <tr><td> </td><td> </td><td> </td></tr> <tr><td> </td><td> </td><td> </td></tr> <tr><td> </td><td> </td><td> </td></tr> <tr><td> </td><td> </td><td> </td></tr> <tr><td> </td><td> </td><td> </td></tr> <tr><td> </td><td> </td><td> </td></tr> <tr><td> </td><td> </td><td> </td></tr> <tr><td> </td><td> </td><td> </td></tr> <tr><td> </td><td> </td><td> </td></tr> </tbody> </table>	No.	REVISION DESCRIPTION	DATE																															<p>CONSULTANTS:</p> <table style="width: 100%; font-size: small;"> <tr> <td style="width: 33%;"> STRUCTURAL / CIVIL ENGINEER H2B, INC. 1225 N. LOOP WEST, SUITE 800 HOUSTON, TX 77008 (713) 864-2900 </td> <td style="width: 33%;"> MECH / ELEC / PLUMB / TECH ENGINEER SPUR DESIGN 11020 KING STREET, SUITE 350 OVERLAND PARK, KS 66210 (405) 842-6100 </td> <td style="width: 33%;"> FIRE PROTECTION ENGINEER POOLE FIRE PROTECTION, INC. 19910 WEST 161ST STREET OLATHE, KANSAS 66062 (913) 829-8690 </td> </tr> <tr> <td> INDUSTRIAL HYGIENIST RSH 3196 N. LOOP WEST, SUITE 800 HOUSTON, TX 77008 (713) 864-2900 </td> <td> HEALTHCARE PLANNER INNOVA GROUP 3196 N. SWAN ROAD TUCSON, AZ 85712 (520) 886-8650 </td> <td> PHYSICAL SECURITY FORCE PROTECT 1225 N. LOOP WEST, SUITE 800 HOUSTON, TX 77008 (713) 864-2900 </td> </tr> </table>	STRUCTURAL / CIVIL ENGINEER H2B, INC. 1225 N. LOOP WEST, SUITE 800 HOUSTON, TX 77008 (713) 864-2900	MECH / ELEC / PLUMB / TECH ENGINEER SPUR DESIGN 11020 KING STREET, SUITE 350 OVERLAND PARK, KS 66210 (405) 842-6100	FIRE PROTECTION ENGINEER POOLE FIRE PROTECTION, INC. 19910 WEST 161ST STREET OLATHE, KANSAS 66062 (913) 829-8690	INDUSTRIAL HYGIENIST RSH 3196 N. LOOP WEST, SUITE 800 HOUSTON, TX 77008 (713) 864-2900	HEALTHCARE PLANNER INNOVA GROUP 3196 N. SWAN ROAD TUCSON, AZ 85712 (520) 886-8650	PHYSICAL SECURITY FORCE PROTECT 1225 N. LOOP WEST, SUITE 800 HOUSTON, TX 77008 (713) 864-2900	<p>ARCHITECT:</p> <p style="font-size: 2em; font-weight: bold; text-align: center;">Spur DESIGN</p> <p style="font-size: small; text-align: center;"> SPUR DESIGN, LLC 312 SW 25TH STREET Oklahoma City, OK 73109 (405) 842-6100 <small>MO ARCH REG. NO. 2012034754, EXP. 12/31/2020 MO ENGR REG. NO. 2014031351, EXP. 12/31/2020</small> </p>	<p>STAMP:</p>	<p>Drawing Title GROUND FLOOR - PHASE 1 ENVIRONMENTAL REMEDIATION</p> <p>VA Health Care System Approval:</p>	<p>Project Title CONSTRUCT INFILL OF BUILDING 26 AND RENOVATE SPECIALTY CARE CLINICS</p> <p>Location 5500 EAST KELLOGG AVENUE WICHITA, KANSAS 67218</p> <p>Date 12/21/2022</p>	<p>Project Number 589-704</p> <p>Building Number 26</p> <p>Drawing Number HA-001</p> <p>Drawing # 8 OF 190</p>	<p>Veterans Health Administration</p> <p style="font-size: x-small;">U.S. Department of Veterans Affairs</p>
No.	REVISION DESCRIPTION	DATE																																													
STRUCTURAL / CIVIL ENGINEER H2B, INC. 1225 N. LOOP WEST, SUITE 800 HOUSTON, TX 77008 (713) 864-2900	MECH / ELEC / PLUMB / TECH ENGINEER SPUR DESIGN 11020 KING STREET, SUITE 350 OVERLAND PARK, KS 66210 (405) 842-6100	FIRE PROTECTION ENGINEER POOLE FIRE PROTECTION, INC. 19910 WEST 161ST STREET OLATHE, KANSAS 66062 (913) 829-8690																																													
INDUSTRIAL HYGIENIST RSH 3196 N. LOOP WEST, SUITE 800 HOUSTON, TX 77008 (713) 864-2900	HEALTHCARE PLANNER INNOVA GROUP 3196 N. SWAN ROAD TUCSON, AZ 85712 (520) 886-8650	PHYSICAL SECURITY FORCE PROTECT 1225 N. LOOP WEST, SUITE 800 HOUSTON, TX 77008 (713) 864-2900																																													

1 2 3 4 5 6 7 8 9

three inches = one foot
 one and one half inches = one foot
 one inch = one foot
 three quarters inch = one foot
 one half inch = one foot
 one quarter inch = one foot
 three eighths inch = one foot
 one eighth inch = one foot
 one quarter inch = one foot
 one eighth inch = one foot
 one quarter inch = one foot
 one eighth inch = one foot



KEY NOTES

- A1** REMOVE EXTERIOR CAGES AND WINDOW ASSEMBLIES WITH UNDERLYING HIDDEN ASBESTOS CAULK WITHIN A NEGATIVE PRESSURE ENCLOSURE, 3 WINDOW ASSEMBLIES.
- A2** REMOVE REMAINING WINDOW SUB-ASSEMBLY WITH UNDERLYING HIDDEN ASBESTOS CAULK WITHIN A NEGATIVE PRESSURE ENCLOSURE, 1 WINDOW ASSEMBLY.
- A3** REMOVE NON-ASBESTOS DRYWALL WALL TO ACCESS HIDDEN WINDOW SUB-ASSEMBLY BEHIND INTERIOR WALL. WHERE PRESENT, REMOVE WINDOW ASSEMBLY COMPONENTS WITH UNDERLYING ASBESTOS CAULK WITHIN A NEGATIVE PRESSURE ENCLOSURE, 5 WINDOW ASSEMBLIES.
- A4** REMOVE WINDOW ASSEMBLIES WITH UNDERLYING HIDDEN ASBESTOS CAULK WITHIN A NEGATIVE PRESSURE ENCLOSURE 14 WINDOW ASSEMBLIES.
- A5** REMOVE NON-ASBESTOS MINERAL WOOL PIPE INSULATION WITH ASBESTOS SEALANT USING GLOVEBAG METHODS WITHIN A NEGATIVE PRESSURE ENCLOSURE, 150 FT
- A6** REMOVE DUCTBOARD INSULATION WITH ASBESTOS WHITE SEAM AND STICK PIN SEALANT USING MANUAL NON-DESTRUCTIVE METHODS WITHIN A NEGATIVE PRESSURE ENCLOSURE, 650 SF
- A7** REMOVE PRESUMED ASBESTOS FIRE DOORS AND FRAMES AND ASSOCIATED CAULKS WITHIN A NEGATIVE PRESSURE ENCLOSURE, 1 DOOR AND FRAME.
- A8** REMOVE NON-ASBESTOS FLOOR COVERING AND UNDERLYING ASBESTOS BLACK MASTIC USING MANUAL MEANS WITHIN A NEGATIVE PRESSURE ENCLOSURE, 3,700 SF MASTIC UNDER FLOOR TILE, QUARRY TILE, CARPET, FREEZERS, OR SNAP FLOORING.
- A9** REMOVE HVAC DUCT INSULATION WITH ASBESTOS WHITE SEAM SEALANT USING MANUAL NON-DESTRUCTIVE METHODS WITHIN A NEGATIVE PRESSURE ENCLOSURE, 200 SF
- A10** REMOVE NON-ASBESTOS PLASTER CHASE AND ASBESTOS PIPE INSULATION USING GLOVEBAG METHODS WITHIN A NEGATIVE PRESSURE ENCLOSURE, 70 SF AND 50 LF.
- L1** REMOVE WINDOW ASSEMBLIES WITH LBP PAINTED SUB-COMPONENTS AND SCRAPE AND STABILIZE METAL LINTELS WITHIN A NEGATIVE PRESSURE CONTAINMENT, 28 ASSEMBLIES
- L2** REMOVE LEAD GLAZED FLOOR BASIN AND ORANGE LBP CABINET IN WHOLE, 1 CERAMIC BASIN, AND 1 SET SHELVING
- L3** REMOVE LEAD CONTAINING CERAMIC WALL TILES WITHIN A NEGATIVE PRESSURE CONTAINMENT, 125 SF.
- AREA NOT WITHIN PROJECT OR PHASE SCOPE

1 GROUND FLOOR - PHASE 2 ENVIRONMENTAL REMEDIATION
 1/8" = 1'-0"

**FULLY SPRINKLERED
 100% BID SET**

<table border="1"> <thead> <tr> <th>No.</th> <th>REVISION DESCRIPTION</th> <th>DATE</th> </tr> </thead> <tbody> <tr><td> </td><td> </td><td> </td></tr> <tr><td> </td><td> </td><td> </td></tr> <tr><td> </td><td> </td><td> </td></tr> <tr><td> </td><td> </td><td> </td></tr> <tr><td> </td><td> </td><td> </td></tr> <tr><td> </td><td> </td><td> </td></tr> <tr><td> </td><td> </td><td> </td></tr> <tr><td> </td><td> </td><td> </td></tr> <tr><td> </td><td> </td><td> </td></tr> <tr><td> </td><td> </td><td> </td></tr> <tr><td> </td><td> </td><td> </td></tr> </tbody> </table>	No.	REVISION DESCRIPTION	DATE																																		CONSULTANTS: STRUCTURAL / CIVIL ENGINEER H2B, INC. 1225 N. LOOP WEST, SUITE 800 HOUSTON, TX 77008 (713) 864-2900 INDUSTRIAL HYGIENIST RSH 1225 N. LOOP WEST, SUITE 800 HOUSTON, TX 77008 (713) 864-2900			MECH / ELEC / PLUMB / TECH ENGINEER SPUR DESIGN 11200 KING STREET, SUITE 350 OVERLAND PARK, KS 66210 (405) 842-6100 HEALTHCARE PLANNER INNOVA GROUP 3198 N SWAN ROAD TUCSON, AZ 85712 (520) 886-8650			FIRE PROTECTION ENGINEER POOLE FIRE PROTECTION, INC. 19910 WEST 161ST STREET OLATHE, KANSAS 66062 (913) 829-8690 PHYSICAL SECURITY FORCE PROTECT 1225 N. LOOP WEST, SUITE 800 HOUSTON, TX 77008 (713) 864-2900			ARCHITECT:  SPUR DESIGN SPUR DESIGN, LLC 312 SW 25TH STREET Oklahoma City, OK 73109 (405) 842-6100 MO ARCH REG. NO. 2012034754, EXP. 12/31/2020 MO ENGR REG. NO. 2014031351, EXP. 12/31/2020			STAMP: 			Drawing Title GROUND FLOOR - PHASE 2 ENVIRONMENTAL REMEDIATION VA Health Care System Approval:			Project Title CONSTRUCT INFILL OF BUILDING 26 AND RENOVATE SPECIALTY CARE CLINICS Location 5500 EAST KELLOGG AVENUE WICHITA, KANSAS 67218 Date 12/21/2022			Project Number 589-704 Building Number 26 Drawing Number HA-002 Drawing # 9 OF 190			Veterans Health Administration  U.S. Department of Veterans Affairs		
	No.	REVISION DESCRIPTION	DATE																																																												
VA FORM 08-6231	1	2	3	4	5	6	7	8	9																																																						

three eighths inch = one foot
 one quarter inch = one foot
 one eighth inch = one foot
 one half inch = one foot
 three quarters inch = one foot
 one inch = one foot
 one and one half inches = one foot
 two inches = one foot
 three inches = one foot
 four inches = one foot
 five inches = one foot
 six inches = one foot
 seven inches = one foot
 eight inches = one foot
 nine inches = one foot
 ten inches = one foot
 eleven inches = one foot
 twelve inches = one foot

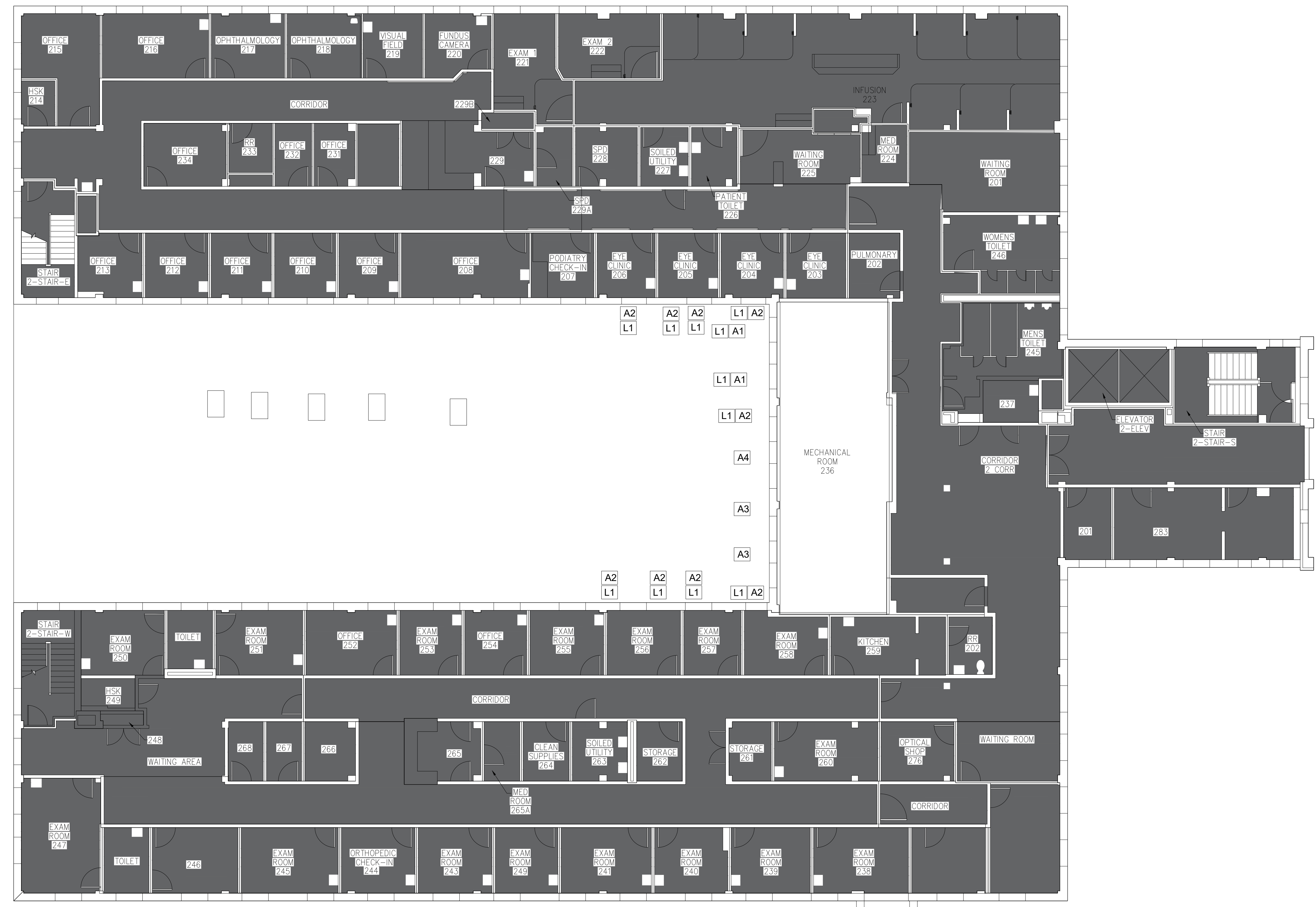
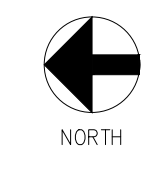

KEY NOTES

- A1** REMOVE LOUVER AND REMAINING WINDOW SUB-ASSEMBLY WITH UNDERLYING HIDDEN ASBESTOS CAULK WITHIN A NEGATIVE PRESSURE ENCLOSURE, 1 LOUVER SYSTEM AND 2 WINDOW SUB-ASSEMBLIES.
 - A2** REMOVE WINDOW ASSEMBLY WITH UNDERLYING HIDDEN ASBESTOS SEAL CAULK WITHIN A NEGATIVE PRESSURE ENCLOSURE, 9 WINDOW ASSEMBLIES.
 - A3** LOUVER SYSTEM WITH REMAINING HISTORIC WINDOW SUB-ASSEMBLIES WITH UNDERLYING HIDDEN ASBESTOS CAULK, PROTECT AS NECESSARY.
 - A4** WINDOW ASSEMBLY WITH UNDERLYING HIDDEN ASBESTOS SEAL CAULK, PROTECT AS NECESSARY.
 - L1** REMOVE WINDOW ASSEMBLIES WITH LBP PAINTED SUBCOMPONENTS AND SCRAPE AND STABILIZE METAL LINTELS AT LOUVER AND WINDOW ASSEMBLY LOCATIONS WITHIN A NEGATIVE PRESSURE CONTAINMENT, 11 LINTELS AT LOUVER AND WINDOW ASSEMBLIES.
- AREA NOT WITHIN SCOPE OF WORK

1 SECOND FLOOR - PHASE 1 ENVIRONMENTAL REMEDIATION
 1/8" = 1'-0"

**FULLY SPRINKLERED
 100% BID SET**

No.	REVISION DESCRIPTION	DATE

CONSULTANTS:

STRUCTURAL / CIVIL ENGINEER H2B, INC. 1225 N. LOOP WEST, SUITE 800 HOUSTON, TX 77008 (713) 864-2900	MECH / ELEC / PLUMB / TECH ENGINEER SPUR DESIGN 11020 KING STREET, SUITE 350 OVERLAND PARK, KS 66210 (415) 842-6100	FIRE PROTECTION ENGINEER POOLE FIRE PROTECTION, INC. 19910 WEST 161ST STREET OLATHE, KANSAS 66062 (913) 829-8690
INDUSTRIAL HYGIENIST RSH 1225 N. LOOP WEST, SUITE 800 HOUSTON, TX 77008 (713) 864-2900	HEALTHCARE PLANNER INNOVA GROUP 3196 N SWAN ROAD TUCSON, AZ 85712 (520) 886-8650	PHYSICAL SECURITY FORCE PROTECT 1225 N. LOOP WEST, SUITE 800 HOUSTON, TX 77008 (713) 864-2900

ARCHITECT:

SPUR DESIGN

SPUR DESIGN, LLC
 312 SW 25TH STREET
 Oklahoma City, OK 73109
 (405) 842-6100

MO ARCH REG. NO. 2012034754, EXP. 12/31/2020
 MO ENGR REG. NO. 2014031351, EXP. 12/31/2020

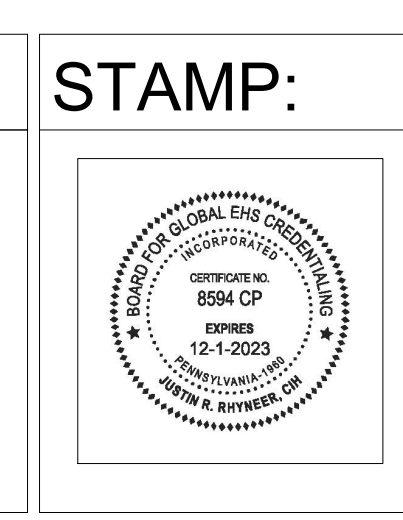

Drawing Title
**SECOND FLOOR - PHASE 1 ENVIRONMENTAL
 REMEDIATION**

VA Health Care System Approval:

Project Title
**CONSTRUCT INFILL OF
 BUILDING 26 AND RENOVATE
 SPECIALTY CARE CLINICS**

Location
 5500 EAST KELLOGG AVENUE
 WICHITA, KANSAS 67218

Date: 12/21/2022
 Checked: JR
 Drawn: CD

Project Number
 PROJECT NUMBER

Building Number
 BUILDING NAME

Drawing Number
HA-201

Drawing # 12 OF 190

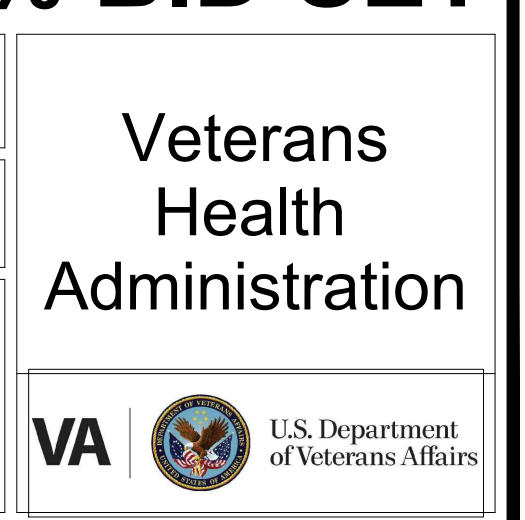

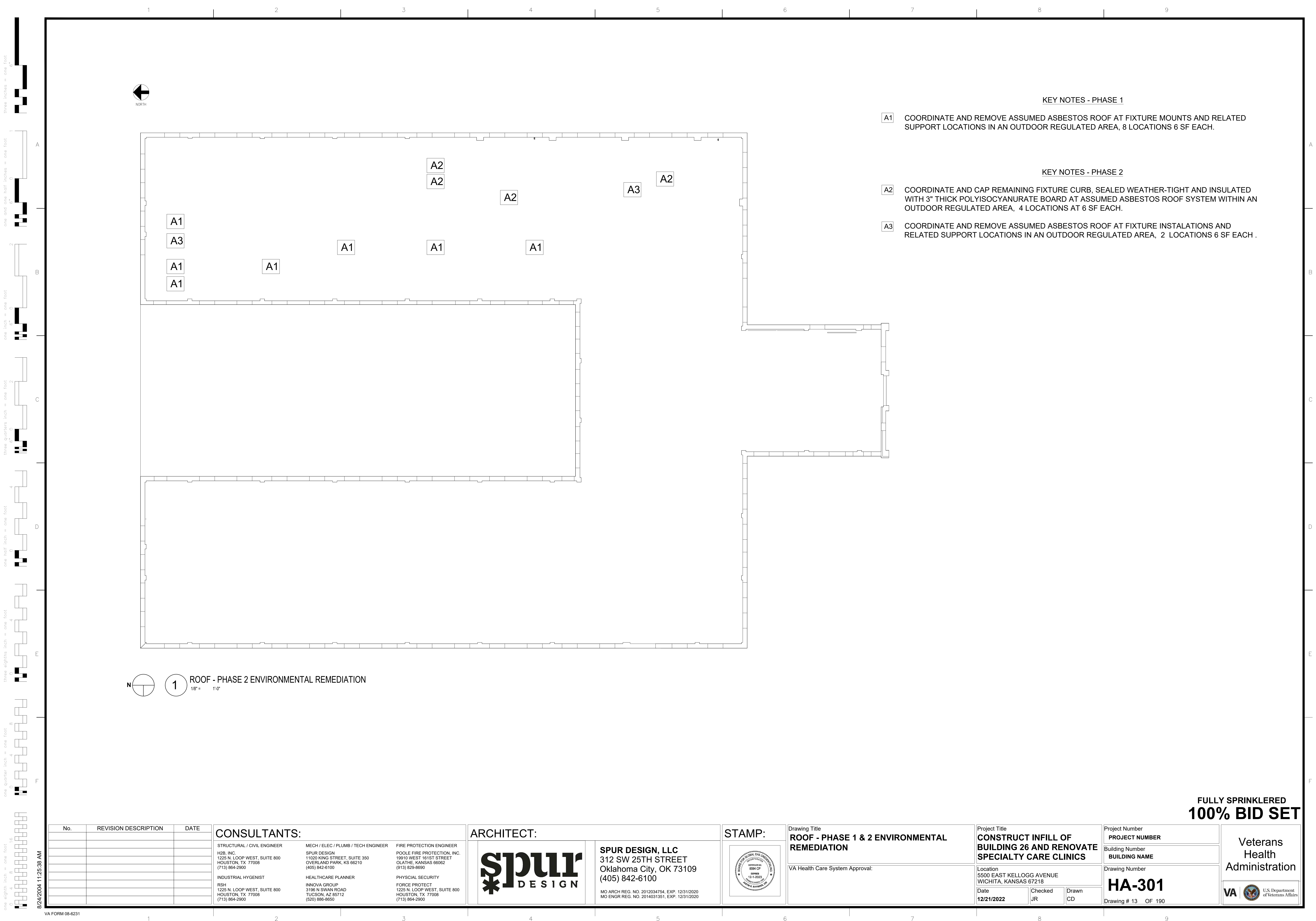

KEY NOTES - PHASE 1

A1 COORDINATE AND REMOVE ASSUMED ASBESTOS ROOF AT FIXTURE MOUNTS AND RELATED SUPPORT LOCATIONS IN AN OUTDOOR REGULATED AREA, 8 LOCATIONS 6 SF EACH.

KEY NOTES - PHASE 2

A2 COORDINATE AND CAP REMAINING FIXTURE CURB, SEALED WEATHER-TIGHT AND INSULATED WITH 3" THICK POLYISOCYANURATE BOARD AT ASSUMED ASBESTOS ROOF SYSTEM WITHIN AN OUTDOOR REGULATED AREA, 4 LOCATIONS AT 6 SF EACH.

A3 COORDINATE AND REMOVE ASSUMED ASBESTOS ROOF AT FIXTURE INSTALATIONS AND RELATED SUPPORT LOCATIONS IN AN OUTDOOR REGULATED AREA, 2 LOCATIONS 6 SF EACH.

1 ROOF - PHASE 2 ENVIRONMENTAL REMEDIATION
1/8" = 1'-0"

**FULLY SPRINKLERED
100% BID SET**

No.	REVISION DESCRIPTION	DATE

CONSULTANTS:

STRUCTURAL / CIVIL ENGINEER H2B, INC. 1225 N. LOOP WEST, SUITE 800 HOUSTON, TX 77008 (713) 864-2900	MECH / ELEC / PLUMB / TECH ENGINEER SPUR DESIGN 11020 KING STREET, SUITE 350 OVERLAND PARK, KS 66210 (405) 842-6100	FIRE PROTECTION ENGINEER POOLE FIRE PROTECTION, INC. 19910 WEST 161ST STREET OLATHE, KANSAS 66062 (913) 829-8690
INDUSTRIAL HYGIENIST RSH 1225 N. LOOP WEST, SUITE 800 HOUSTON, TX 77008 (713) 864-2900	HEALTHCARE PLANNER INNOVA GROUP 3180 N SWAN ROAD TUCSON, AZ 85712 (520) 886-8650	PHYSICAL SECURITY FORCE PROTECT 1225 N. LOOP WEST, SUITE 800 HOUSTON, TX 77008 (713) 864-2900

ARCHITECT:



SPUR DESIGN, LLC
 312 SW 25TH STREET
 Oklahoma City, OK 73109
 (405) 842-6100

MO ARCH REG. NO. 2012034754, EXP. 12/31/2020
 MO ENGR REG. NO. 2014031351, EXP. 12/31/2020

STAMP:



Drawing Title
**ROOF - PHASE 1 & 2 ENVIRONMENTAL
 REMEDIATION**

VA Health Care System Approval:

Project Title
**CONSTRUCT INFILL OF
 BUILDING 26 AND RENOVATE
 SPECIALTY CARE CLINICS**

Location
 5500 EAST KELLOGG AVENUE
 WICHITA, KANSAS 67218

Date
12/21/2022

Checked
 JR

Drawn
 CD



Project Number
PROJECT NUMBER

Building Number
BUILDING NAME

Drawing Number
HA-301

Drawing # 13 OF 190

**Veterans
 Health
 Administration**

8/24/2004 11:25:38 AM